

Parsons Grove

Architect	Gaastra, Gladding, and Johnson
Date of Construction	1928
Name Origin	Named for Josephine Parsons who served as, University Secretary and Financial Secretary from 1894 to 1927.
Primary Materials	Grass, trees and shrubs.



Figure 54: Parsons Grove, 2006

Historical Significance

Parsons Grove, located between Sara Reynolds Hall and the Communication and Journalism Building, is a naturalistic landscape in the Romantic tradition (Figure 54). The original planting plan was designed by the firm of Gaastra, Gladding, and Johnson, the architects for the nearby Monte Vista Elementary School. Judge C. M. Botts provided the funding as a gift to the University in Josephine Parsons' name.

Originally, the grove was made up of 250 Chinese Elm trees purchased from New Mexico State University. Over the years as the elms died, other tree species have been planted including a variety of evergreens, one of which is one of the largest cedars on the campus. The grounds are covered with turf and a forked asphalt path crosses from Redondo Drive to Central Avenue. A circular flower garden is located southeast of Sara Reynolds Hall.

This landscape is an important continuation of the Tight Grove, which indicates presence of a landscaped oasis within the campus. It is probably not eligible for either the State or National Register because the nature of the landscape has changed significantly since its original form, especially with regard to the density of trees. Early documents suggest the grove originally contained as many as 250 trees, if this is correct, the present size of this landscape (a few dozen trees) offers a very different impression to the visitor (Figure 55).

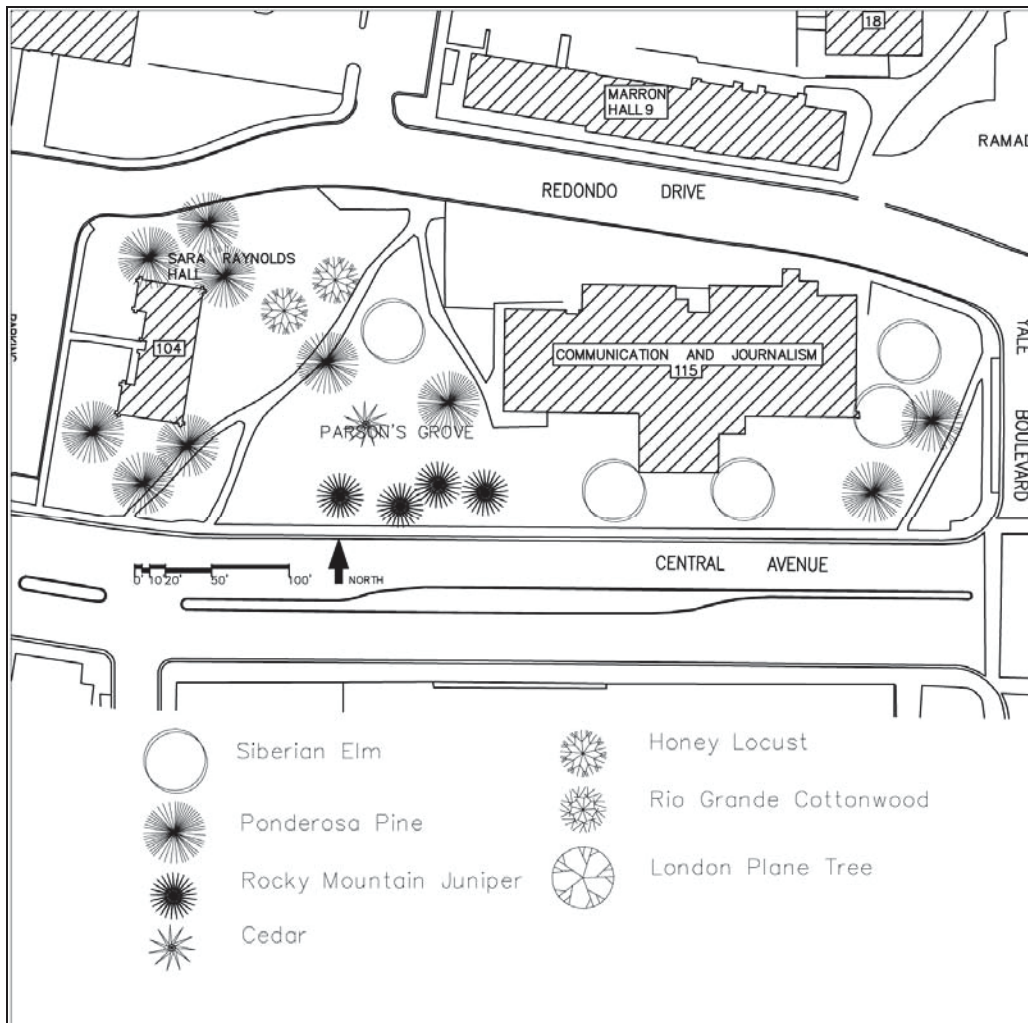

Figure 55: Plan view of Parson's Grove

Source: Will Moses, 2006

Character Defining Features

- Generally flat topography
- Variety of tree species, more evergreens than deciduous; more trees to the north than the south.
- Curvilinear path
- Low wood retaining wall
- Large planting bed of flowers

Important Views of this Setting

- As one walks or drives along Redondo Drive and Central Avenue in either direction.
- From the windows of Sara Raynolds Hall and the Communication and Journalism Building